

# SIGNATURE

## NORTH EAST

OFFICIALLY RATED THE NO.1 ESTATE AGENT IN THE NORTH EAST







Hawkins Way, Blyth NE24 3US



# Hawkins Way Blyth NE24 3US

Offers Over £550,000

Signature North East are delighted to introduce this stunning four bedroom detached home to the sales market, immaculately presented and boasting spacious, modern living with incredibly tasteful décor and styling throughout. Situated on Hawkins Way, Blyth, this amazing property also benefits from being in the ideal location, desirably close to the coast, and offering a range of convenient local amenities such as shops, eateries, and schooling at all levels making this the perfect potential family home.

The property begins in the welcoming entrance hallway, which presents access to the staircase, an exclusive study or home office, perfect for those working from home, and all principal rooms. First is the living room, showcasing neutral décor for a luxurious, relaxing feel, and double French doors to the garden which flood the room with natural light. Adjacent is the spacious open plan kitchen diner, boasting a bright and airy feel, and displaying an incredibly modern design with a mirror wall, and equipped with additional double French doors opening up the space. The kitchen offers a variety of integrated appliances and a range of fitted base, drawer and wall units in a pristine white finish. Connected is a handy downstairs W.C, and a utility room, with access to the garage.

Upstairs to the first floor are the bedrooms, all offer ample space, and two of which provide access to the Jack and Jill ensuite. The master bedroom is generously sized and maintains the pristine, elegant look notable throughout the home, also offering the luxury of an exclusive dressing room and a four-piece ensuite. Completing this floor is a three-piece family bathroom suite.

Externally, this wonderful property provides double glazing throughout, a double drive and a double garage for off-street parking, and a welcoming gravel garden to the front. To the rear finds an extremely sizeable garden, designed to an exceptional standard, with a two-tier paved patio, a generous amount of artificial lawn space, and a timber play area, creating an exquisite place to relax out in the sun or for spending quality time with friends and family.

Property could be reverted back to 5 bedroom as per original plans.

Council Tax Band: E

Tenure: Freehold

Community Charge: £120 per annum







### Why Signature?

Signature North East reach 150,000 per month on social media. We cover 19 locations in the North East. At signature we keep our doors open from 8AM - 8PM, when other estate agents are closed. We are a customer 5 star rated agent on allagents.co.uk. With a dedicated group of negotiators across the region, to the 'behind the scenes' Head Office team, each member of staff is passionate about the industry and cares about every client; you're at the heart of everything we do!

PLEASE NOTE THAT THE VENDOR HAS CERTIFIED THE PROPERTY INFORMATION AND IMAGES.

# PROPERTY FLOORPLAN

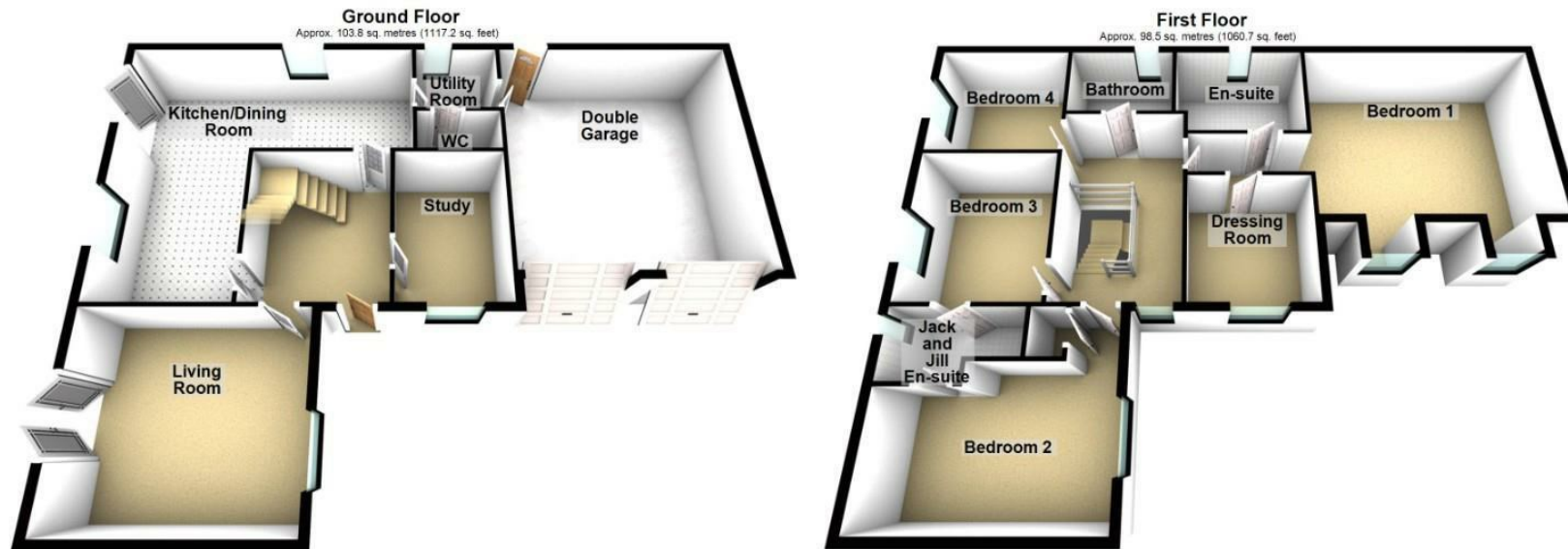

Total area: approx. 202.3 sq. metres (2177.9 sq. feet)  
Please be advised the floorplans are not drawn to scale and are to be used to give an idea of the layout of the property.  
Plan produced using PlanUp.

EPC RATING: C





More 5 Star Customer Reviews than any other Agent based in the North East on [allAgents.co.uk](https://allagents.co.uk)



**SALES**

**LETTINGS**

**FINANCE**

**LAW**

**WE COVER THE WHOLE OF THE NORTH EAST**

Whitley Bay  
0191 251 3344

Cramlington  
01670 897 213

Tynemouth  
0191 296 6689

Morpeth  
01670 513 966

Ponteland  
01661 820 082

Wallsend  
0191 432 4151

Alnwick  
01665 511 800

Heaton  
0191 432 4275

Forest Hall  
0191 266 9966

Other locations  
0191 640 3523

Newcastle  
0191 640 2284

Durham  
0191 303 8252

Gosforth  
0191 640 3523

Sunderland  
0191 543 6390

Whickham  
0191 432 5102

Gateshead  
0191 432 4294

Jesmond  
0191 281 1037

Killingworth  
0191 640 3602

Ryton  
0191 413 9845

Head Office &  
Lettings  
0191 253 4815

\*Highest recommended 5-star reviews than any other Estate Agent based in the North East on [allAgents.co.uk](https://allagents.co.uk) - The UK's Largest Customer Review Website for the Property Industry & Awarded Best Estate Agency 2018 & 2019 - North East England by SME News